

Canon

PowerShot
SX740 HS

Getting Started **ENGLISH**

Manuals and Software

For more information about the camera, look for feature guidance displayed on the camera, or refer to the *Camera User Guide* that can be downloaded from the Canon website.



Download camera and lens manuals and software from the following page.

<http://www.canon.com/icpd/>

- With a computer connected to the Internet, access the above URL.
- Access the site for your country or region.
- Adobe Reader is required to view the manuals.
- For instructions on downloading and installing the software, refer to the downloaded manuals.
- You can also access the manuals and software webpage from a QR code that you can display on the camera. To display the QR code, choose MENU > [Function settings] > [Manual/software URL].

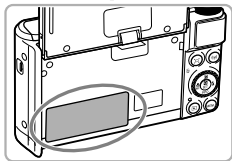

You may be requested to enter the serial number (body number) when downloading the manuals or software.

In this case, enter the number on the camera body, behind the screen (monitor).

Preliminary Notes and Legal Information

- Take and review some test shots initially to make sure the images were recorded correctly. Please note that Canon Inc., its subsidiaries and affiliates, and its distributors are not liable for any consequential damages arising from any malfunction of a camera or accessory, including memory cards, that result in the failure of an image to be recorded or to be recorded in a way that is machine readable.
- The user's unauthorized photographing or recording (video and/or sound) of people or copyrighted materials may invade the privacy of such people and/or may violate others' legal rights, including copyright and other intellectual property rights. Note that restrictions may apply even when such photographing or recording is intended solely for personal use.
- For information on camera warranty or Customer Support, please refer to the warranty information provided with your camera User Manual Kit.
- Although the screen is produced under extremely high-precision manufacturing conditions and more than 99.99% of the pixels meet design specifications, in rare cases some pixels may be defective or may appear as red or black dots. This does not indicate camera damage or affect recorded images.
- When the camera is used over an extended period, it may become warm. This does not indicate damage.

Safety Instructions

- Be sure to read these instructions in order to operate the product safely.
- Follow these instructions to prevent injury or harm to the operator of the product or others.



WARNING

Denotes the risk of serious injury or death.

- **Keep the product out of the reach of young children.**

A strap wrapped around a person's neck may result in strangulation.

- **Use only power sources specified in this instruction manual for use with the product.**

- **Do not disassemble or modify the product.**

- **Do not expose the product to strong shocks or vibration.**

- **Do not touch any exposed internal parts.**

- **Stop using the product in any case of unusual circumstances such as the presence of smoke or a strange smell.**

- **Do not use organic solvents such as alcohol, benzene or paint thinner to clean the product.**

- **Do not get the product wet.**

- **Do not insert foreign objects or liquids into the product.**

- **Do not use the product where flammable gases may be present.**

This may cause electric shock, explosion or fire.

- **For products featuring a viewfinder, do not look through the viewfinder at strong light sources such as the sun on a bright day or lasers and other strong artificial light sources.**

This may harm your vision.

- **Observe the following instructions when using commercially available batteries or provided battery packs.**

- **Use batteries/battery packs only with their specified product.**

- **Do not heat batteries/battery packs or expose them to fire.**

- **Do not charge batteries/battery packs using non-authorized battery chargers.**

- **Do not expose the terminals to dirt or let them come into contact with metallic pins or other metal objects.**

- **Do not use leaking batteries/battery packs.**

- **When disposing of batteries/battery packs, insulate the terminals with tape or other means.**

This may cause electric shock, explosion or fire.

If a battery/battery pack leaks and the material contacts your skin or clothing, flush the exposed area thoroughly with running water. In case of eye contact, flush thoroughly with copious amounts of clean running water and seek immediate medical assistance.

- **Observe the following instructions when using a battery charger or AC adapter.**

- **Periodically remove any dust buildup from the power plug and power outlet using a dry cloth.**

- **Do not plug in or unplug the product with wet hands.**

- **Do not use the product if the power plug is not fully inserted into the power outlet.**

- **Do not expose the power plug and terminals to dirt or let them come into contact with metallic pins or other metal objects.**

- **Do not touch the battery charger or AC adapter connected to a power outlet during lightning storms.**

- **Do not place heavy objects on the power cord. Do not damage, break or modify the power cord.**

- **Do not wrap the product in cloth or other materials when in use or shortly after use when the product is still warm in temperature.**

- **Do not leave the product connected to a power source for long periods of time.**

This may cause electric shock, explosion or fire.

- **Do not allow the product to maintain contact with the same area of skin for extended periods of time during use.**

This may result in low-temperature contact burns, including skin redness and blistering, even if the product does not feel hot. The use of a tripod or similar equipment is recommended when using the product in hot places and for people with circulation problems or less sensitive skin.

- **Follow any indications to turn off the product in places where its use is forbidden.**

Not doing so may cause other equipment to malfunction due to the effect of electromagnetic waves and even result in accidents.



CAUTION

Denotes the risk of injury.

- **Do not fire the flash near the eyes.**

It may hurt the eyes.

- **Strap is intended for use on the body only. Hanging the strap with any product attached on a hook or other object may damage the product. Also, do not shake the product or expose the product to strong impacts.**
- **Do not apply strong pressure on the lens or allow an object to hit it.**

This may cause injury or damage to the product.

- **Flash emits high temperatures when fired. Keep fingers, any other part of your body, and objects away from the flash unit while taking pictures.**

This may cause burns or malfunction of the flash.

- **Do not leave the product in places exposed to extremely high or low temperatures.**

The product may become extremely hot/cold and cause burns or injury when touched.

CAUTION

Denotes the possibility of property damage.

- **Do not aim the camera at intense light sources, such as the sun on a clear day or an intense artificial light source.**

Doing so may damage the image sensor or other internal components.

- **When using the camera on a sandy beach or at a windy location, be careful not to allow dust or sand to enter the camera.**
- **Wipe off any dust, grime, or other foreign matter on the flash with a cotton swab or cloth.**

The heat emitted from the flash may cause foreign matter to smoke or the product to malfunction.

- **Remove and store the battery pack/batteries when you are not using the product.**

Any battery leakage that occurs may cause product damage.

- **Before you discard the battery pack/batteries, cover the terminals with tape or other insulators.**

Contacting other metal materials may lead to fire or explosions.

- **Unplug any battery charger used with the product when not in use. Do not cover with a cloth or other objects when in use.**

Leaving the unit plugged in for a long period of time may cause it to overheat and distort, resulting in fire.

- **Do not leave any dedicated battery packs near pets.**

Pets biting the battery pack could cause leakage, overheating, or explosion, resulting in product damage or fire.

- **If your product uses multiple batteries, do not use batteries that have different levels of charge together, and do not use old and new batteries together. Do not insert the batteries with the + and – terminals reversed.**

This may cause the product to malfunction.

- **Do not sit down with the camera in your pant pocket.**

Doing so may cause malfunctions or damage the screen.

Initial Preparations

Attaching the Strap

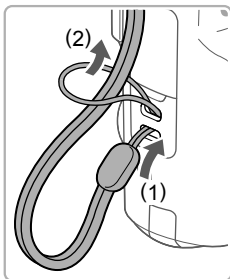

Charging the Battery Pack

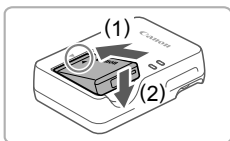

1 Insert the battery pack in the charger.

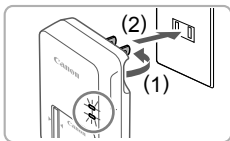

2 Charge the battery pack.

- Lamp colors
 - Charging: Orange
 - Fully charged: Green

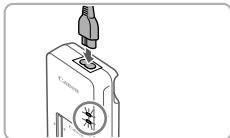

Inserting the Battery Pack and Your Memory Card

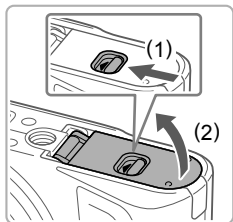

1 Open the cover.

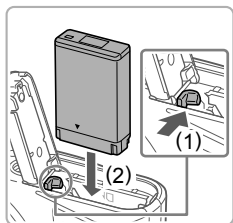

2 Insert the battery pack.

To remove:

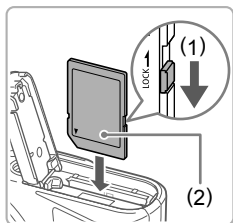
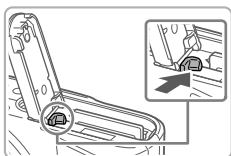

3 Check your card's write-protect switch and insert the memory card.

To remove:

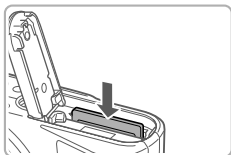

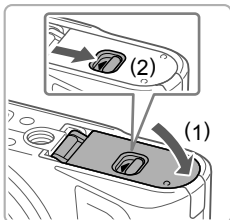

4 Close the cover.

Compatible Memory Cards (Sold Separately)

- SD memory cards*1
- SDHC memory cards*1*2
- SDXC memory cards*1*2



*1 Cards conforming to SD standards. However, not all memory cards have been verified to work with the camera.

*2 UHS-I memory cards are also supported.

Setting the Date, Time, and Time Zone

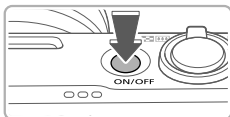

1 Turn the camera on.

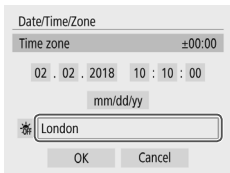



2 Set the time zone.

- Press the ◀/▶ buttons to choose the item, and then press the Ⓜ button.



| Time zone | |
|---------------------|--------|
| 02/02/2018 10:10:00 | |
| Azores | -01:00 |
| London | ±00:00 |
| Paris | +01:00 |
| Cairo | +02:00 |
| Moscow | +03:00 |



- Press the  button again, press the ▲ /▼ buttons to choose a time zone, and then press the .

| Date/Time/Zone | |
|-----------------------------------|---------------------------------------|
| (02/02/2018) | |
| 02 . 02 . 2018 | 10 : 10 : 00 |
| mm/dd/yy | |
| 🌐 London | |
| <input type="button" value="OK"/> | <input type="button" value="Cancel"/> |

- Choose [OK] to return to [Date/Time/Zone].

| Date/Time/Zone | |
|-----------------------------------|---------------------------------------|
| (02/02/2018) | |
| 02 . 02 . 2018 | 10 : 10 : 00 |
| mm/dd/yy | |
| 🌐 London | |
| <input type="button" value="OK"/> | <input type="button" value="Cancel"/> |

3 Set the date and time.

- Press the ◀/▶ buttons to navigate and the  button to select an item, press the ▲/▼ buttons to adjust the date and time, and then press the .
- Choose [OK] and press the .

Display Language

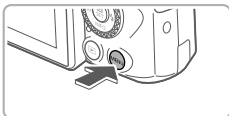

1 Access the menu screen.

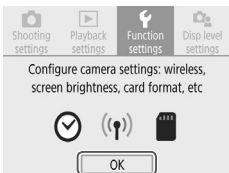

2 Choose the function settings menu.

- Press the ◀/▶ buttons to choose [F], and then press the Ⓜ button.

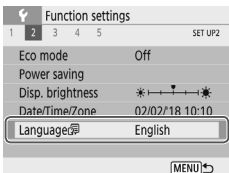

3 Choose [Language].

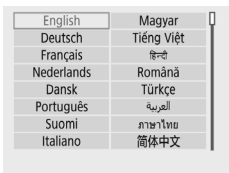

4 Set the display language.

Trying the Camera Out

Shooting

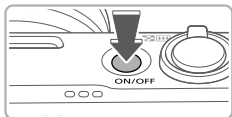

1 Turn the camera on.

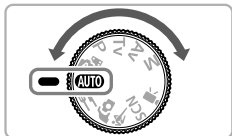

2 Enter AUTO mode.

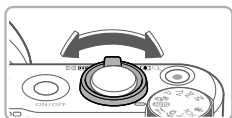

3 Zoom in or out, as needed.

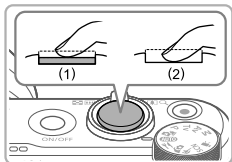

4 Shoot.

Shooting Still Images

1) Focus. (1)

- The camera beeps twice after focusing.
- An AF point is displayed around positions in focus.

2) Shoot. (2)

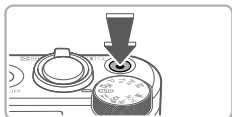

Recording Movies

- Press again to stop recording.

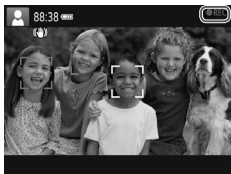

- [●REC] is displayed during recording.

Viewing

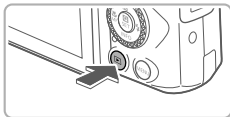

1 Switch to playback.

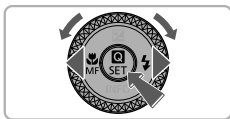

2 Choose images.

- Movies are labeled with [SET] [M/AF].
Press the [SET] button.



3 Play movies.

- Press the [SET] button.
- Press the ▲/▼ buttons to adjust the volume.

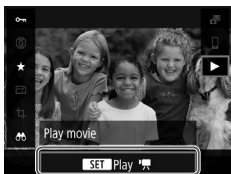

Trademarks and Licensing

- The SDXC logo is a trademark of SD-3C, LLC.

Disclaimer

- Unauthorized reproduction of this guide is prohibited.
- Illustrations and screenshots in this guide may differ slightly from the actual equipment.

Only for European Union and EEA (Norway, Iceland and Liechtenstein)



These symbols indicate that this product is not to be disposed of with your household waste, according to the WEEE Directive (2012/19/EU), the Battery Directive (2006/66/EC) and/or national legislation implementing those Directives.

If a chemical symbol is printed beneath the symbol shown above, in accordance with the Battery Directive, this indicates that a heavy metal (Hg = Mercury, Cd = Cadmium, Pb = Lead) is present in this battery or accumulator at a concentration above an applicable

threshold specified in the Battery Directive.

This product should be handed over to a designated collection point, e.g., on an authorized one-for-one basis when you buy a new similar product or to an authorized collection site for recycling waste electrical and electronic equipment (EEE) and batteries and accumulators. Improper handling of this type of waste could have a possible impact on the environment and human health due to potentially hazardous substances that are generally associated with EEE. Your cooperation in the correct disposal of this product will contribute to the effective usage of natural resources.

For more information about the recycling of this product, please contact your local city office, waste authority, approved scheme or your household waste disposal service or visit www.canon-europe.com/weee, or www.canon-europe.com/battery.

CAUTION

RISK OF EXPLOSION IF BATTERY IS REPLACED BY AN INCORRECT TYPE.

DISPOSE OF USED BATTERIES ACCORDING TO LOCAL REGULATION.

To ensure proper operation of this product, use of genuine Canon accessories is recommended.

- Interface Cable IFC-600PCU

HDMI cable (camera end: TypeD): Use a commercially available cable no longer than 2.5m.

The model number is PC2352 (including WLAN module and BLE module model WM600). To identify your model, check the label on the bottom of the camera or behind the tilt-up screen for a number beginning with PC.

Countries and Regions Permitting Wireless Function Use

- Use of wireless function is restricted in some countries and regions, and illegal use may be punishable under national or local regulations. To avoid violating wireless regulations, visit the Canon website to check where use is allowed.

Note that Canon cannot be held liable for any problems arising from wireless function use in other countries and regions.

Doing any of the following may incur legal penalties:

- Altering or modifying the product

- Removing the certification labels from the product

Do not use the wireless function of this product near medical equipment or other electronic equipment.

Use of the wireless function near medical equipment or other electronic equipment may affect operation of those devices.

Hereby, Canon Inc. declares that this equipment is in compliance with Directive 2014/53/EU.

The full text of the EU declaration of conformity is available at the following internet address:

<http://www.canon-europe.com/ce-documentation>

Wi-Fi Frequency range: 2412 – 2462MHz

Wi-Fi Maximum output power: 11.7dBm

Bluetooth Frequency range: 2402 – 2480MHz

Bluetooth Maximum output power: 9.7dBm

CANON EUROPA N.V. Bovenkerkerweg 59, 1185 XB Amstelveen, The Netherlands

CANON INC. 30-2, Shimomaruko 3-chome, Ohta-ku, Tokyo 146-8501, Japan

Some logos for technical standards the camera has met can be viewed on the screen by choosing MENU ► [5] tab ► [Certification Logo Display].